

PLAN SHOWING THE PROPOSED RESIDENTIAL FLAT AT PLOT NO. B, DOOR NO. 14/7, IN T.S. NO. 170/1, BLOCK NO. 20, OF RAMANUJA KODAM STREET, CHOOLAIMEDU, PULIYUR VILLAGE, CHENNAI 94. DIV. 77, Z-5.

NOTE: - EXG DEMOLITION & SUBDIVISION PLAN APPROVED BY COR OF CHENNAI S D NO: 05/361/2001 DATE: 26/1/2001

SCALE 1"=80' (1:100)

REFERENCE			
MD	MAIN DOOR	33" X 70"	100 X 213
D1	DOOR	30" X 70"	90 X 213
D2		26" X 70"	76 X 213
W	WINDOW	50" X 46"	152 X 137
W1		26" X 46"	137 X 137
V	VENTILATOR	30" X 26"	90 X 76
FW	FRENCH WINDOW	50" X 70"	183 X 213

COLOUR INDEX	
PRO	
ROAD	
BOUN	

AREA DETAILS		
	sqft	m ²
PLOT AREA	2064	191.82
PARKING AREA	420.75	39.10
G.F AREA	915.75	85.10
F.F AREA (above stilt)	1336.50	124.21
S.F AREA	531	49.34
TOTAL AREA	2783.25	258.66
PLOT COVERAGE	64.75%	
F.S.I	1.34	
HEAD ROOM AREA	97.50	9.06

OWNER

 PH: 4831510
 A. Anandaram, D.C.E.,
 THIRUMALA PLANNERS
 CONSULTING CIVIL ENGINEER
 LICENSED SURVEYOR L.S. NO. 9
 NO. 223/A, PALANI ANDAVAR KOIL STREET,
 VADAPALAI, CHENNAI - 600 026.
 9/1/2001 ENGINEER

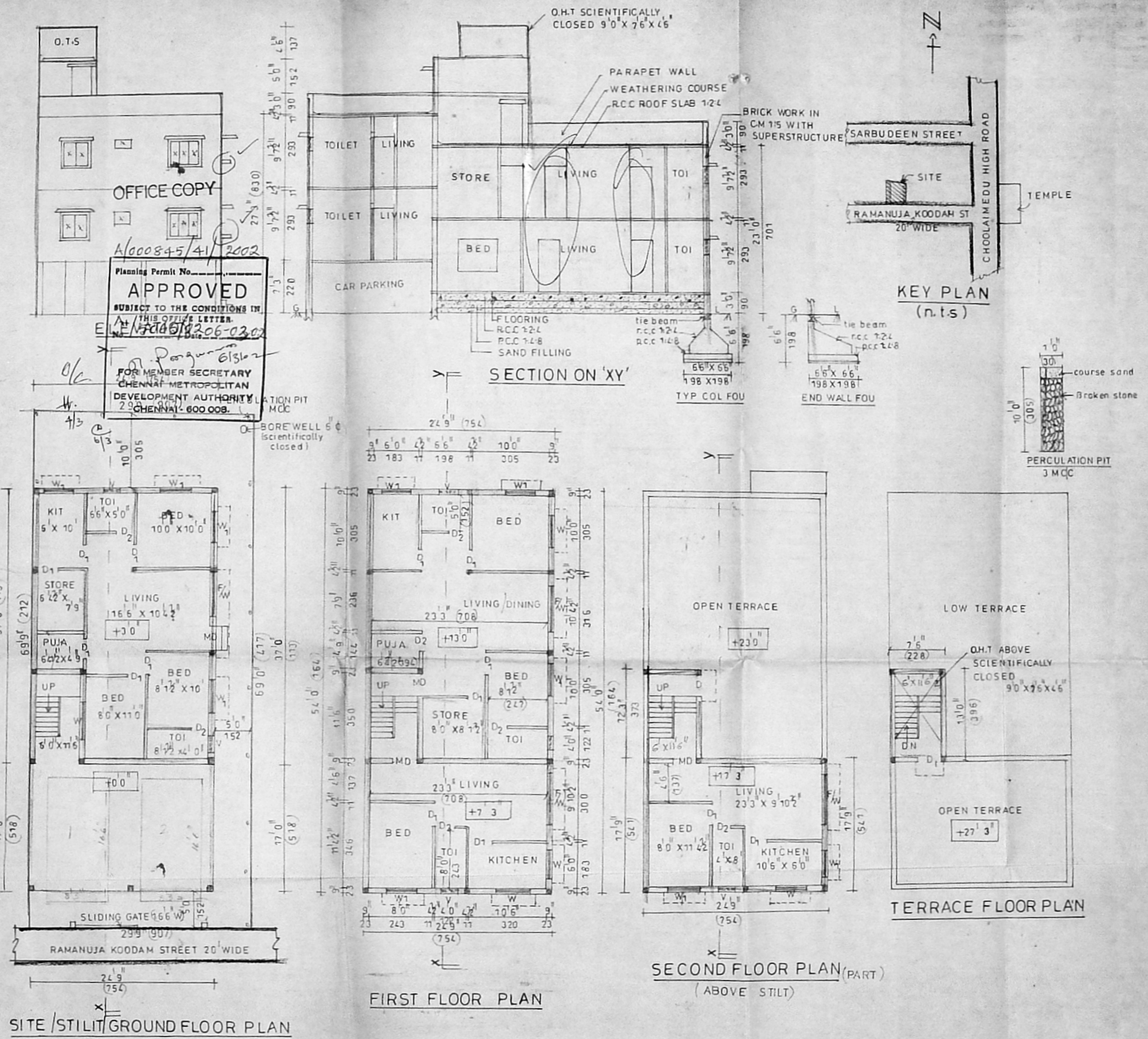

OFFICE COPY
 A/600845/41/2002
 Planning Permit No. APPROVED
 SUBJECT TO THE CONDITIONS IN THIS OFFICE LETTER.
 Planning Permit No. APPROVED
 FOR MEMBER SECRETARY
 CHENNAI METROPOLITAN
 DEVELOPMENT AUTHORITY
 CHENNAI - 600 008.